

Island Range Hinge Door - Cayman

Installation & Maintenance Instructions

02.21

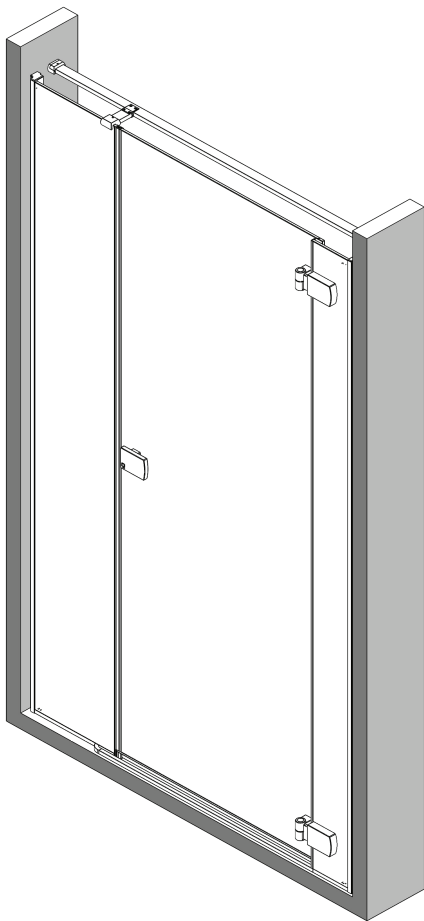

LAKES
SHOWERING SPACES



1x Inline panel
sub assy

1x Complete LK801
In seperate carton

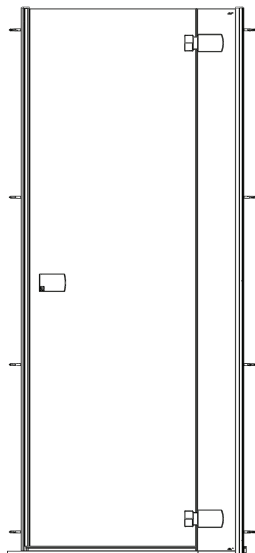

Bracing Kit W8-080

Comprising:

1. Bracing bar (E352-170)
2. Wall bracket (SK-68)

3. 90° Tee bar kit (SK-65)
4. Glass bracket kit (SK-60)

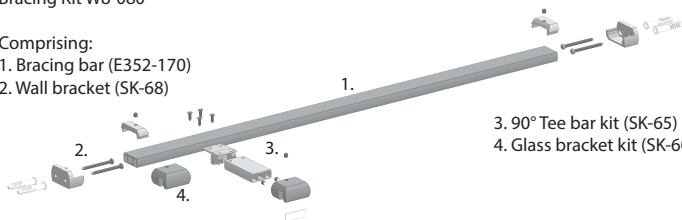

1x Bottom channel
(8036)

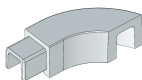

2x Threshold End Trim
handed pair
(8000-20 & 21)



1x '802' Template
(for bracing)
(8000-162)



1x Magnetic Seal
(8015-B)
1988mm

Panels Setup :

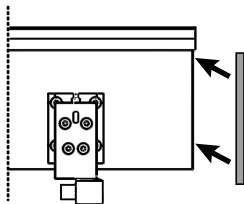
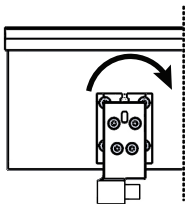

Hinge panel sub assembly is supplied with hinge pins facing one another. Before fitting, offer panel to hinge side wall, reverse the top hinge & fit bottom channel

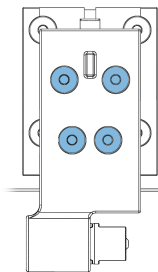

Undo / remove the 4 clamp screws indicated, flip the hinge bracket over, fit & re-tighten the clamp screws. (On completion both hinge pins will be upright).

Apply a continuous bead of clear silicone to the inside of the bottom channel then carefully push upto the vertical profile then onto the glass bottom edge. a mallet or hammer and wood block may be used. Take care not to bend trim!

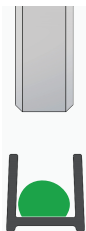

Repeat to fit bottom channel to inline panel

Wall Profile Positioning & Mounting :

To Ensure unit stands on tray correctly, wall profiles **MUST BE POSITIONED AS SPECIFIED**, with foam seal towards the front (outside) of the tray or base.

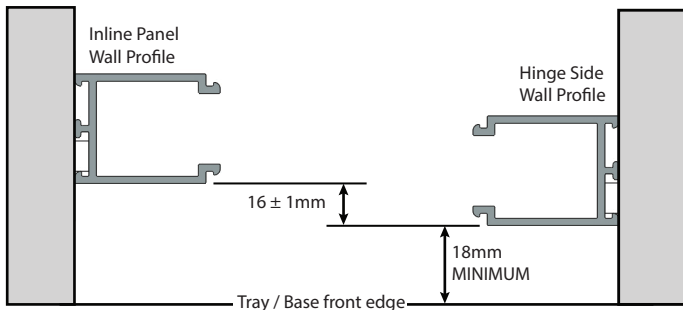

Measure, plumb wall profile & mark screw positions. Drill with 8mm bit, plug & affix wall profiles using 4mm x 45mm screws.

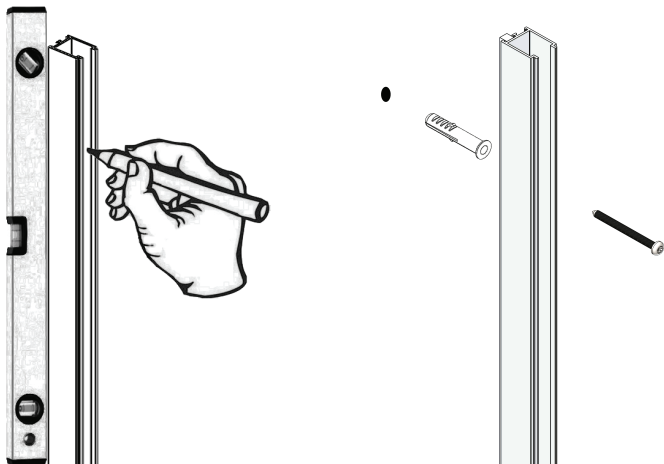

Lift panels onto their wall profiles, push fully back to wall & down onto tray / base.

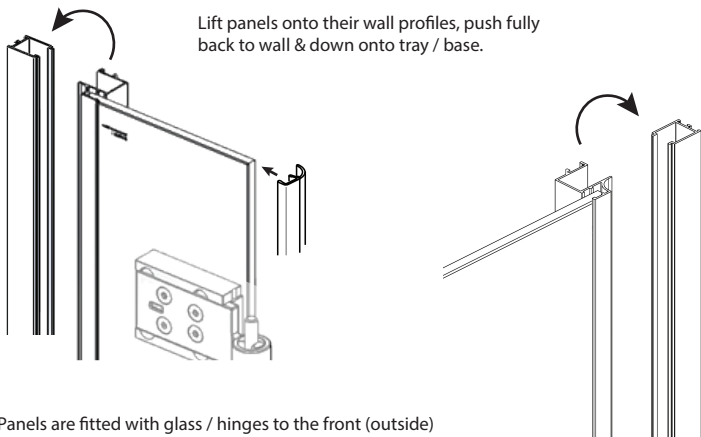

Panels are fitted with glass / hinges to the front (outside)

Align edge seal to top of glass & fit seal to edge of hinge panel (lip to inside)

Wall Brackets :

Engage bracket onto hinge backplate & push upto side wall.

Level and mark hole positions (centre of slots in bracket).

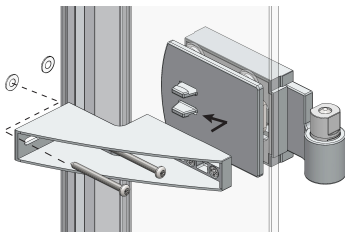

Remove bracket, drill & fit wall plugs. Re-fit bracket & ensuring panel is parallel to tray / base front edge, fix bracket to wall ONLY at this stage.

Door Setup : (RH door shown - reverse for LH)



Ensure one gasket to each face of glass
* Do NOT fit riser & top cap at this stage.
Fully tighten clamp screws.

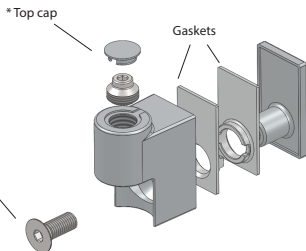

Fit square connecting bar into 1st handle, align M8 hole with dimple & fully tighten grubscrew then back off 1 turn. Fit gasket & pass square bar through glass. Fit 2nd gasket then 2nd handle, press handles together then fully tighten grubscrew in 2nd handle. Re-tighten 1st grubscrew to clamp.

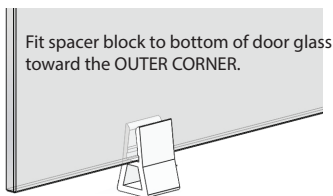
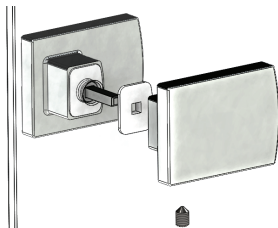

Fit spacer block to bottom of door glass toward the OUTER CORNER.

Door Fitting : 2 PERSONS REQUIRED.

Fit (white plastic) upper hinge risers to hinge pins - in UP position. With door approx 60-90° open, carefully lift door, align both hinges & lower door onto hinge panel, push door towards the closed position until door drops & risers engage correctly.

AFTER ASSEMBLY, DOOR WEIGHT MUST BE SUPPORTED AT ALL TIMES UNTIL HINGE PANEL IS SCREWED TO WALL PROFILE!

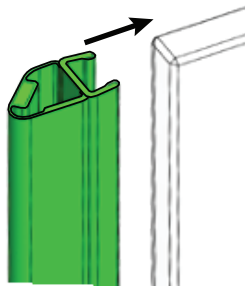
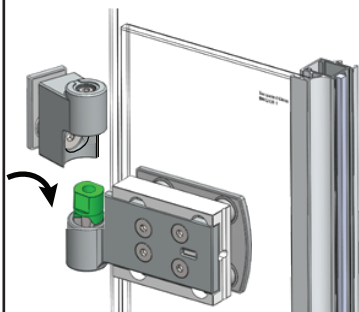

Magnetic seals :
Align seal end with top of glass. Press fit onto door edge.

Adjustment provided : Each wall profile = 15mm. Hinge = 15mm

With door on support block and in closed position, maneuver / adjust hinge panel & inline panel - then hinges - until magnets meet & hold.

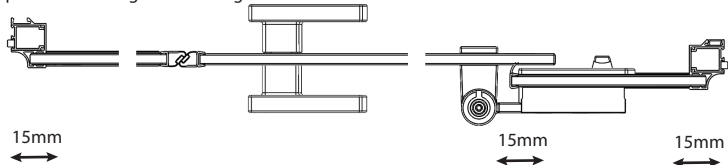

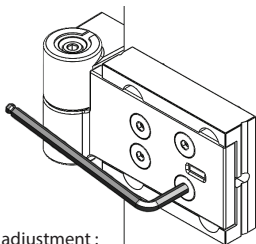

Hinge adjustment :

Loosen 4 clamp screws ONE TURN ONLY.

NEVER REMOVE THESE SCREWS WITH DOOR FITTED!

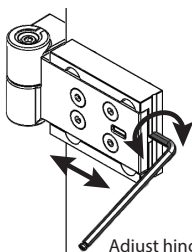

Adjust hinges as necessary
then re-tighten clamp screws

Check all panels are plumb then from inside enclosure, using wall profile holes as a guide.

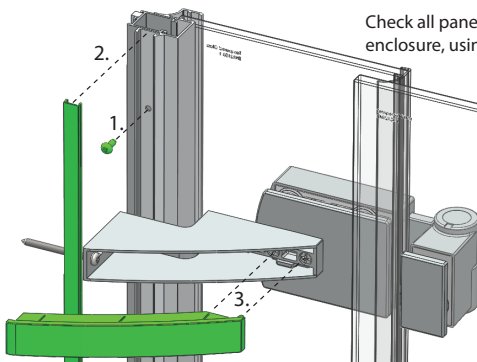

1. Drill dia. 3mm holes, affix panel and striker to wall profiles with 3.5mm x 8mm screws.

2. Fit screw cover sections.

3. Align hinge panel parallel to front of tray / base.

After adjustment tighten all bracket grub screws and fit bracket cover.

Support block may now be removed . Open / close door & re-adjust hinges to fine tune the door magnets. Visually check both hinges for riser clearance, if one shows clearance, turn it's take up screw until castellated faces of white plastic risers are in full contact when door is in closed position.

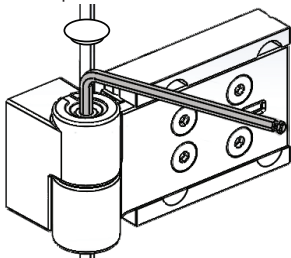

After adjusting 'take up' fit top caps to door hinges

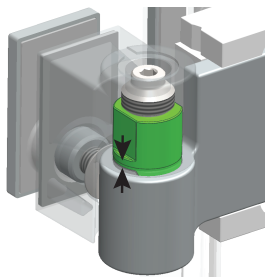

Bottom Seal & Bracing :

As supplied, the bottom seal is over length & requires cutting. With drip lip to inside, offer the seal 2mm from the striker rail (45° faces 2mm apart)

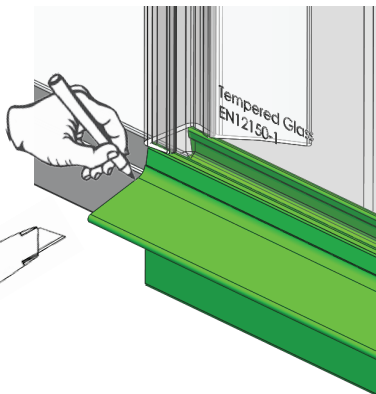
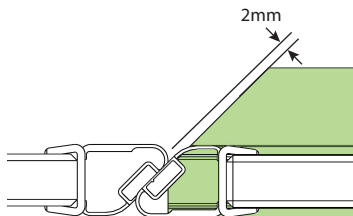

At the hinge side of door glass, mark the seal flush to the glass edge, remove seal & neatly cut to length.

Re-position & press fit seal fully onto door bottom edge.

Adjacent to the top of the wall profile(s), measure the distance from wall to wall, or wall to inside of side panel glass : Xmm. With all brackets removed, cut the bar (only) to X-12mm.

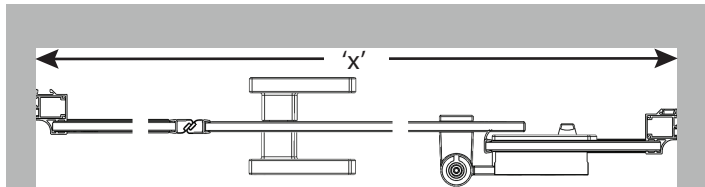

Using the appropriate end of the template, offer upto vertical profile. With template level & flush to top of profile, mark the wall hole positions.

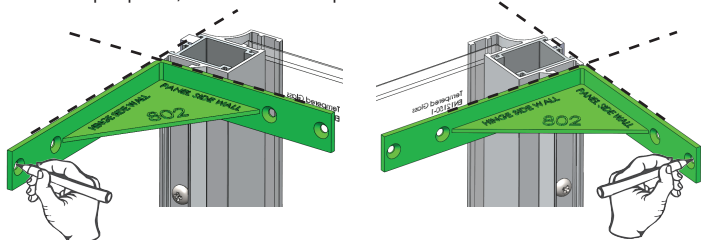

BEFORE DRILLING : Assemble glass brackets onto panels & tighten clamp screws. Position Then offer entire bracing bar into place to check that wall bracket locations are correct.

Drill wall holes, fit wall plugs & affix lower wall brackets & main bracing bar.

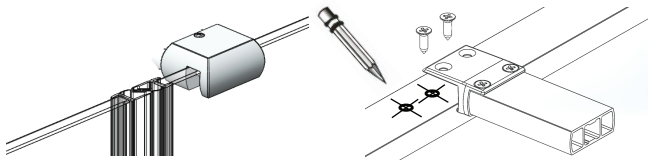

Offer Tee bar into glass clamp & either mark for drilling, or directly drill (dia 3mm) though TOP surface of main bar ONLY. Affix Tee bracket to main bar with 2x CSK screws.

Place bracing bar into the brackets and assemble top clamps as shown. Secure by tightening grubscrews in brackets.

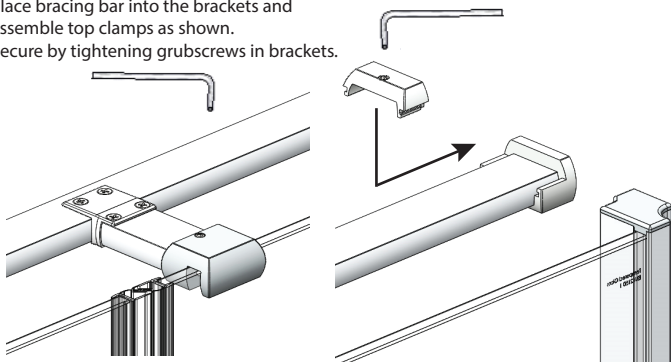

Threshold :

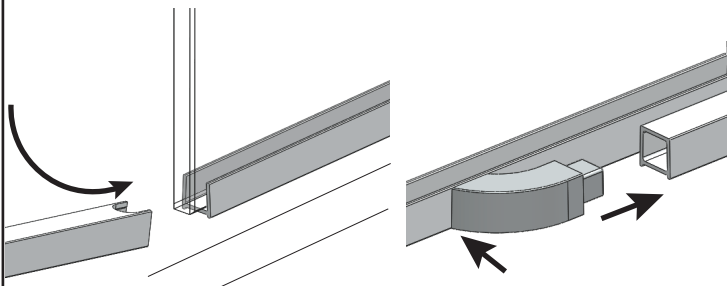

1. Insert scalloped end of bar under glass corner, down to tray/base & up to bottom channel.
2. Push trim into hole in threshold bar & up to face of bottom channel.

Select & fit profile caps.

Top caps are supplied as a handed pair, select the correct top cap for the handing of your enclosure.



Inline panel side

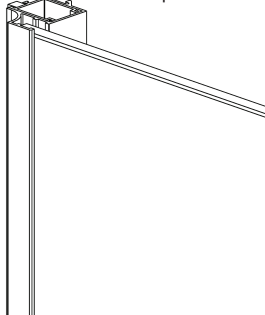

Hinge panel side

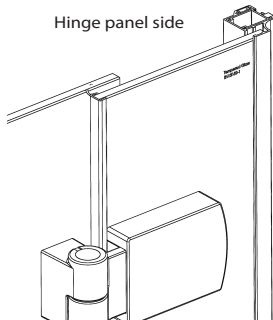

Silicone Sealing :

It is recommended to clean all surfaces before siliconing. With all threshold items in place, aligned as necessary, & with door closed, apply continuous bead of clear silicone sealant as shown.

