

HORIZON - Walk In Shower Panel

Installation / Maintenance Instructions

Rev 02.22



IMPORTANT NOTES :

Please Read Carefully & retain these instructions for Future Reference.

1. For ease & safety we advise that two persons assemble this product.
2. Protect shower tray surfaces at all times.
3. Exposed glass corners / edges **MUST NOT** contact hard surfaces at any time.
4. Check for cables, pipes etc before drilling walls.
5. Ensure all surfaces are dry, clean & free of loose debris / dust.
6. Unpack goods with care (small parts can become lodged in packaging & inadvertently discarded). Check parts supplied against parts & fittings listed herein. Damaged parts / omissions may be resolved by calling Lakes Bathrooms Helpline.
7. Whilst precautions are taken in manufacture, care must be taken when handling as rail ends may have sharp edges.
8. Before commencing, check :
 - a) shower tray (if used) is level & completely sealed to finished / tiled walls.
 - b) finished walls are sound & free of cracks, loose tiles / grout.
8. **AFTER INSTALLATION, DO NOT 'WET' ENCLOSURE FOR 48 HOURS TO ENSURE FULL CURE OF SILICONE SEALANT.**

USE :

General Care & Maintenance.

Provided this product is installed & operated in accordance with these instructions, problems should not arise. However should maintenance be required it should be carried out by a competent person with reference to these instructions. Before any work is carried out the root cause of the problem must be identified. Lakes Bathrooms service engineers are available if necessary to consult / carry out remedial work. Call Lakes Bathrooms HELPLINE.

Cleaning.

(Every one to two weeks depending on local water {hardness} conditions).

All glass panels in this product have a hydrophobic coating aiding 'runoff' of water droplets, reducing the need for frequent cleaning. For best appearance / product life however, regular cleaning is recommended.

Use **ONLY** mild soap / detergent solutions to clean. Rinse with water, squeegee glass panels & wipe frames dry with a soft cloth. Under no circumstances should abrasive, caustic or scouring products be used. **DO NOT** use 'spray & leave' type cleaning products. Non compliance with these cleaning instructions may cause decorative finishes to deteriorate & could adversely affect safe operation of the enclosure.

Limescale ~ should a build up of limescale occur, remove using a 50:50 solution of white vinegar & water applied with a soft cloth & rinsed / dried thoroughly afterwards.

Daily Care.

To prevent the build up of limescale, do not allow water droplets to dry on glass or frames. After showering, rinse with water, remove droplets from glass with a squeegee & wipe frame with a soft cloth.

Customer Service.

Quality Guarantee : Lakes Bathrooms Ltd guarantee Shower Doors & Enclosures against any manufacturing or material defects for the lifetime of the product. We will resolve defects free of charge by repairing / replacing parts as we feel necessary. To be 'free of charge' service work must be carried out by Lakes Bathrooms or approved agents.

Not Covered by this Guarantee : Damage or defects that result from improper installation, improper use, or lack of maintenance (including limescale buildup). Damage or defects that result from repairs / modifications undertaken by unauthorized persons. This guarantee is in addition to statutory & other legal rights.

What to do if something goes wrong : Should the product not function correctly on initial use, firstly, contact the installer to check that unit installation & commissioning are in accordance with these instructions. Should this not resolve difficulties or should performance decline, consult 'Troubleshooting' section to see if simple home maintenance is needed. Alternatively our HELPLINE staff can assist, or if necessary arrange for a service engineer to visit.

Spares : We maintain extensive spare part stocks. Spares can be ordered / purchased from your retailer in the first instance. Parts will normally be dispatched within two working days from order placement. Pro Forma invoices will be sent for cheque payments.

Supplied Parts :

Panel Sub Assy

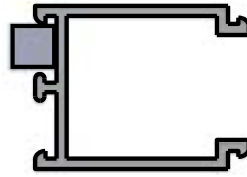
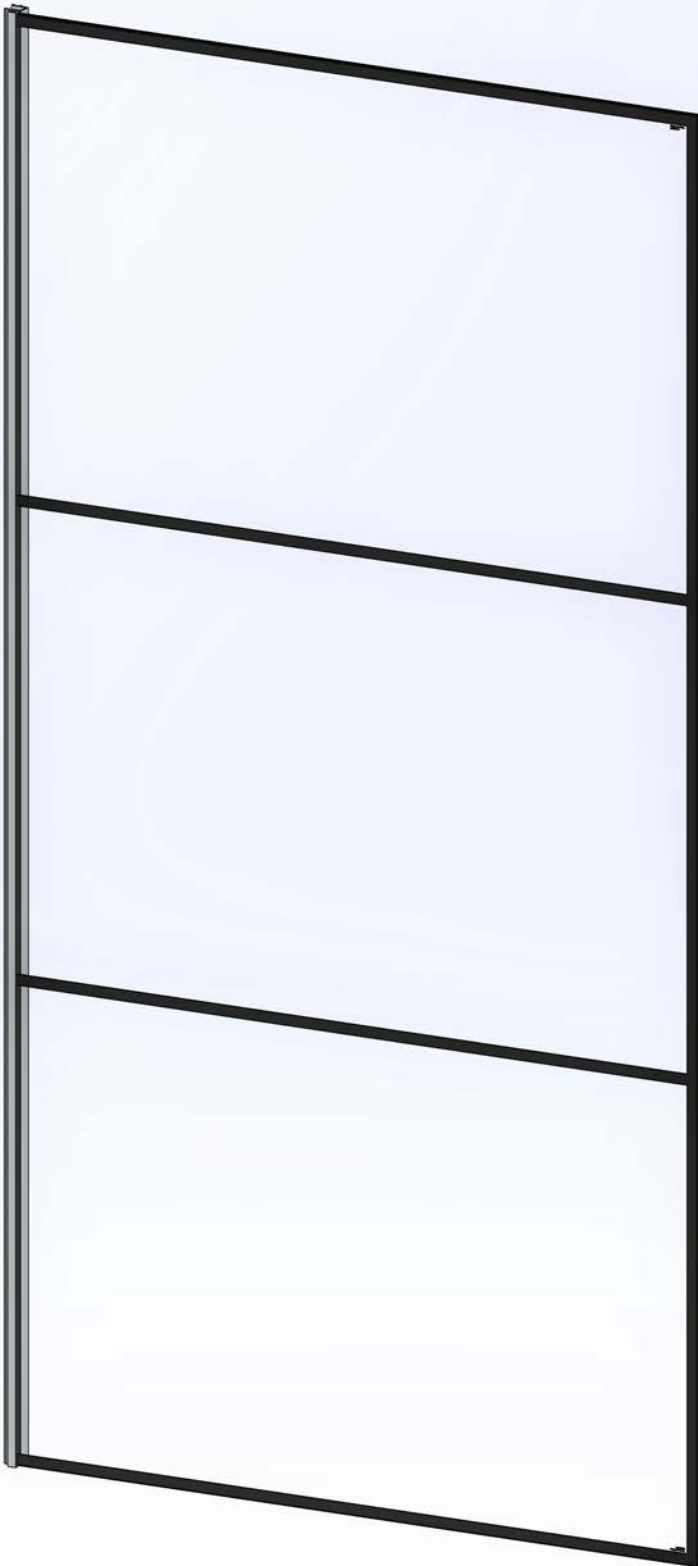

Wall Profile
(with Foam Seal) 1x
(2m long)

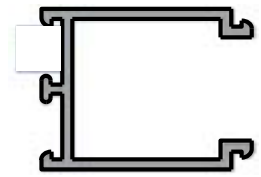

Extension Profile 1x
(2m long)
optional fit

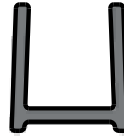

Bottom Trim 1x

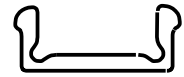

Cover Profile
(screws) 1x



Wall / Ext Profile
Caps 2x

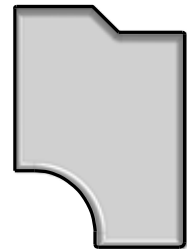

Vert frame Caps
handed pair

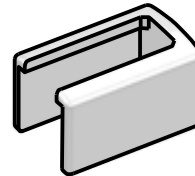

Bottom Trim
End Cap 1x

General Fixings : Wall Screws / Wall Plugs



4x



4x



3x Profile Joining Screws

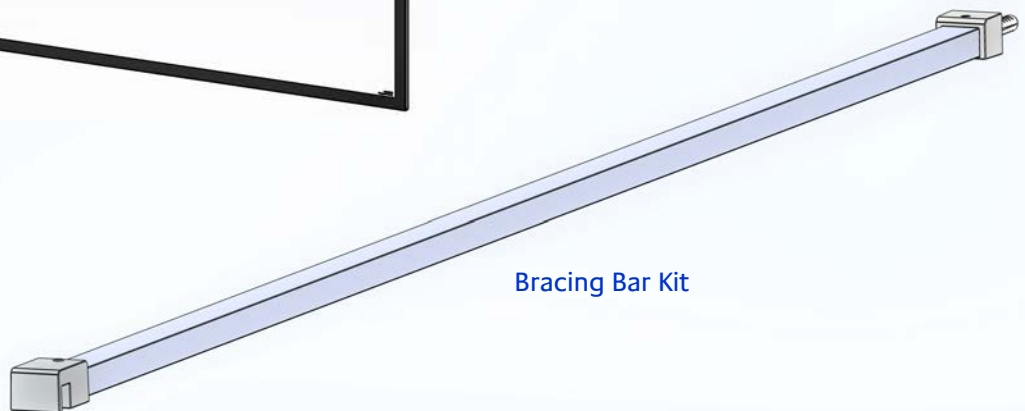

Bracing Bar Kit

Tools Required

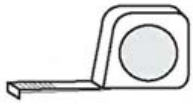

Tape Measure



Pencil

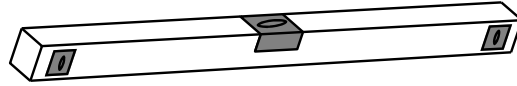

Spirit Level (with vertical 'bubble')

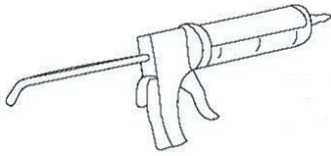

Good quality silicone sealant & applicator



Power drill & 8mm masonry bit

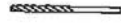

3mm HSS drill bit

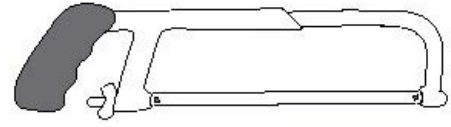

Hacksaw



Pozidriv Screwdriver



2,5mm Hexagon (Allen) Key

Horizon Walk In enclosures are fully reversible. Versatile construction permits their use onto a wide range of base footprints, tray or wetroom installations. Ensure tray / floor is level & that all base / wall joints are sealed & cured over entire length of sides (See Fig A) prior to fitting enclosure.

A Setting Out : **Fitting to Tray** ~ To ensure enclosure is situated entirely on the flat surface of the tray rim, wall profiles should be mounted a minimum of 18mm inboard of tray edges. **Wetroom** ~ Enclosure may be sited as desired in relation to wet area (within size range of product).

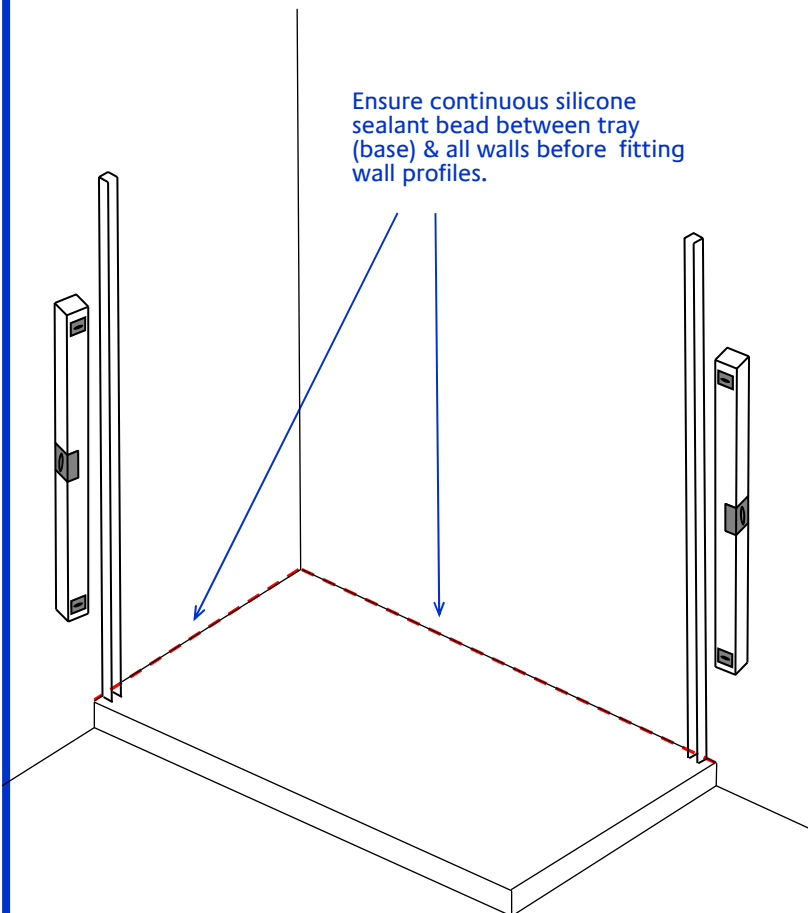

Wall profile orientation : Foam seal outermost (away from wet area). Measure, plumb & mark wall profile positions, drill, plug & affix wall profiles.

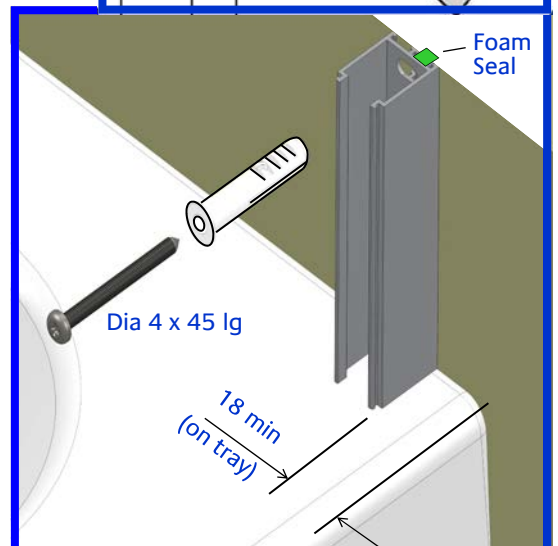
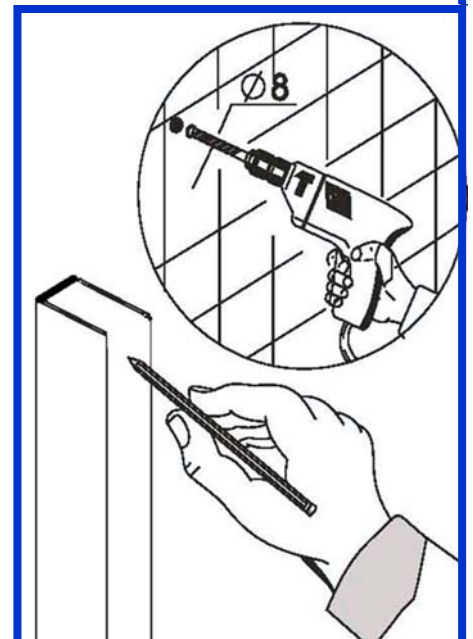

Select Hand ~ Fit bottom trims

Select 'hand' for unit build. Trim is fitted at base only.
Apply a continuous bead of silicone along inside of trim then carefully push trims fully onto bottom edge of glass panel.
Butt trim up to vertical profile. Do not bend or strike with hard objects, a soft mallet or hammer & wooden block should be used if necessary.

(B)

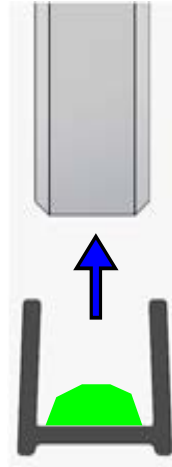

Typical Wall Panel Construction :

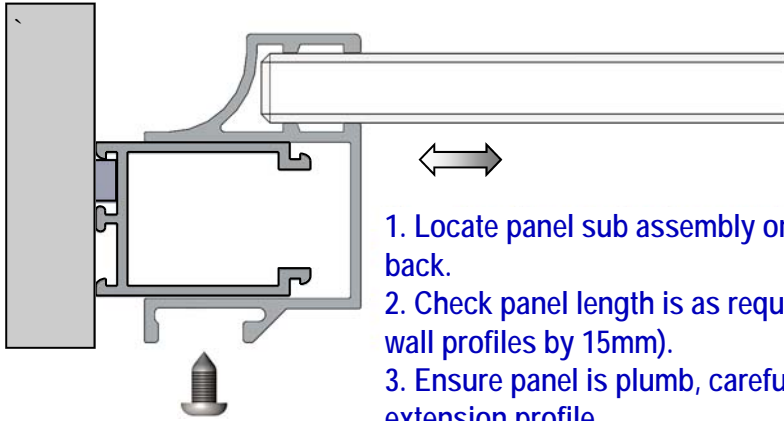

1. Locate panel sub assembly onto extension profile & push fully back.
2. Check panel length is as required (panel may be pulled away from wall profiles by 15mm).
3. Ensure panel is plumb, carefully drill (dia 3mm) & screw panel to extension profile.

Typical extended Panel Construction :

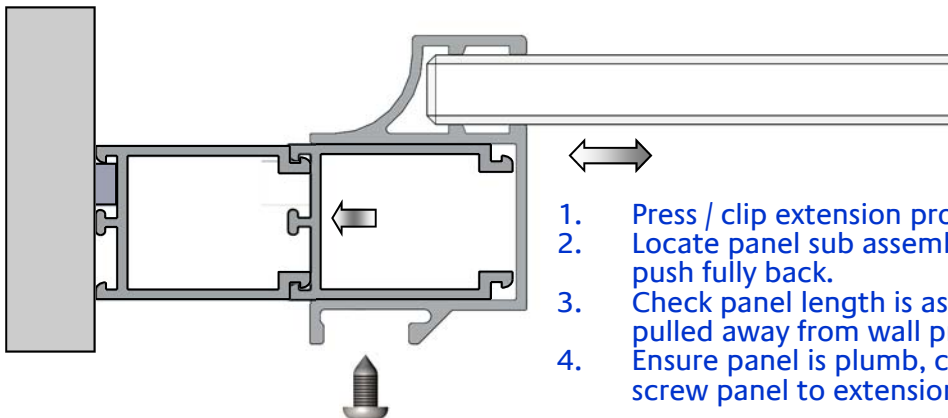

1. Press / clip extension profile onto wall profile.
2. Locate panel sub assembly onto extension profile & push fully back.
3. Check panel length is as required (panel may be pulled away from wall profiles by 15mm).
4. Ensure panel is plumb, carefully drill (dia 3mm) & screw panel to extension profile.

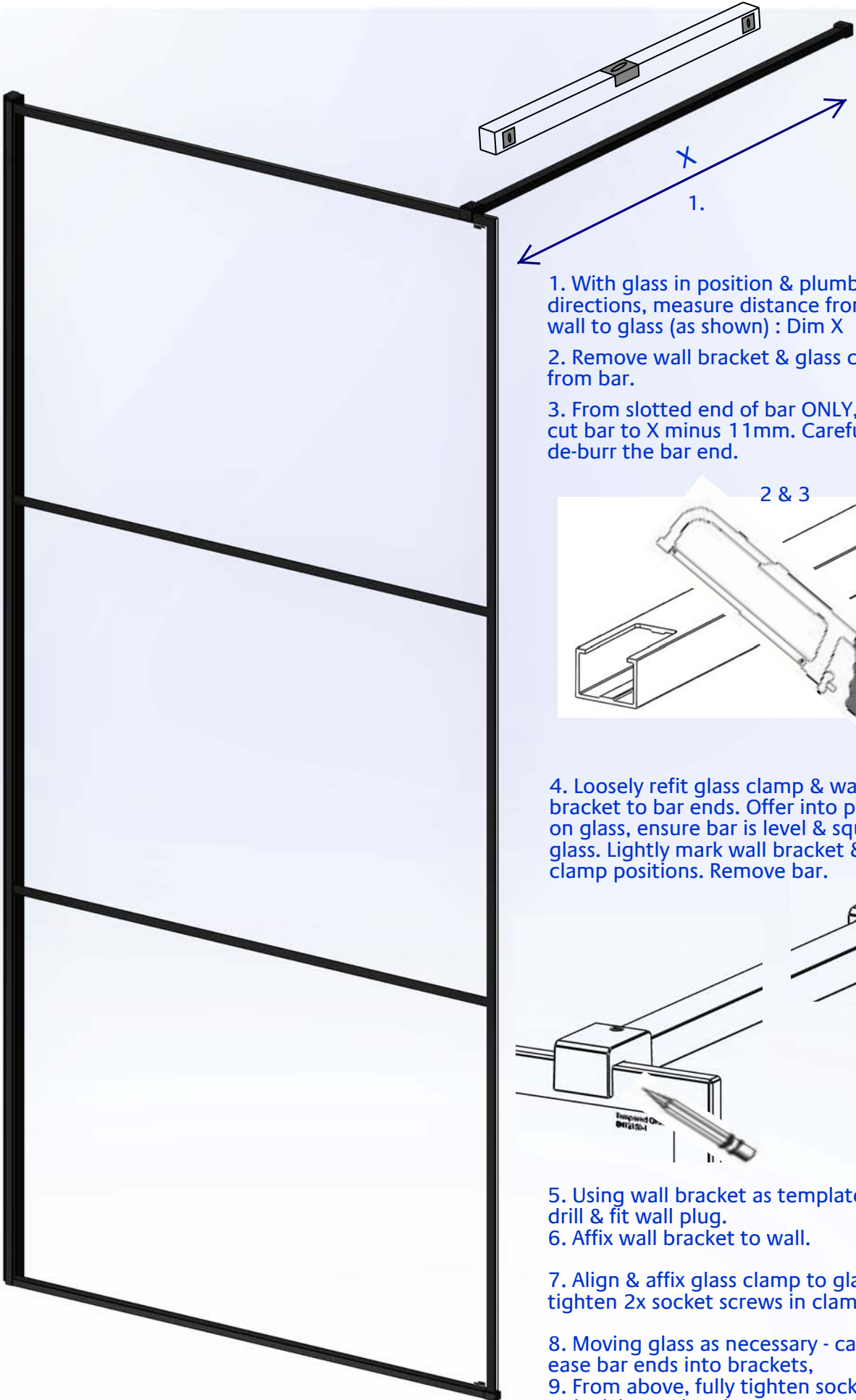

1. With glass in position & plumb in all directions, measure distance from back wall to glass (as shown) : Dim X
2. Remove wall bracket & glass clamp from bar.
3. From slotted end of bar ONLY, mark & cut bar to X minus 11mm. Carefully de-burr the bar end.

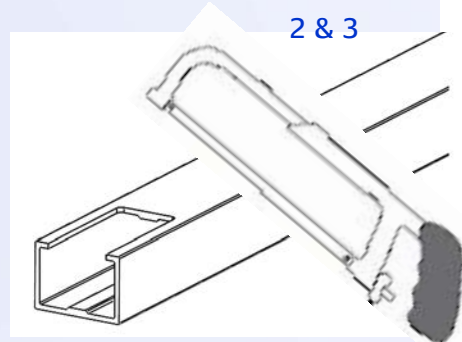

4. Loosely refit glass clamp & wall bracket to bar ends. Offer into position on glass, ensure bar is level & square to glass. Lightly mark wall bracket & glass clamp positions. Remove bar.

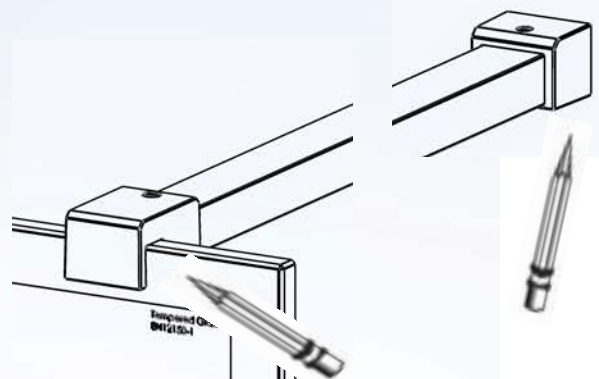

5. Using wall bracket as template, mark, drill & fit wall plug.
6. Affix wall bracket to wall.
7. Align & affix glass clamp to glass (fully tighten 2x socket screws in clamp).
8. Moving glass as necessary - carefully ease bar ends into brackets,
9. From above, fully tighten socket screws to lock bar to brackets.

Top Caps :

Ⓓ

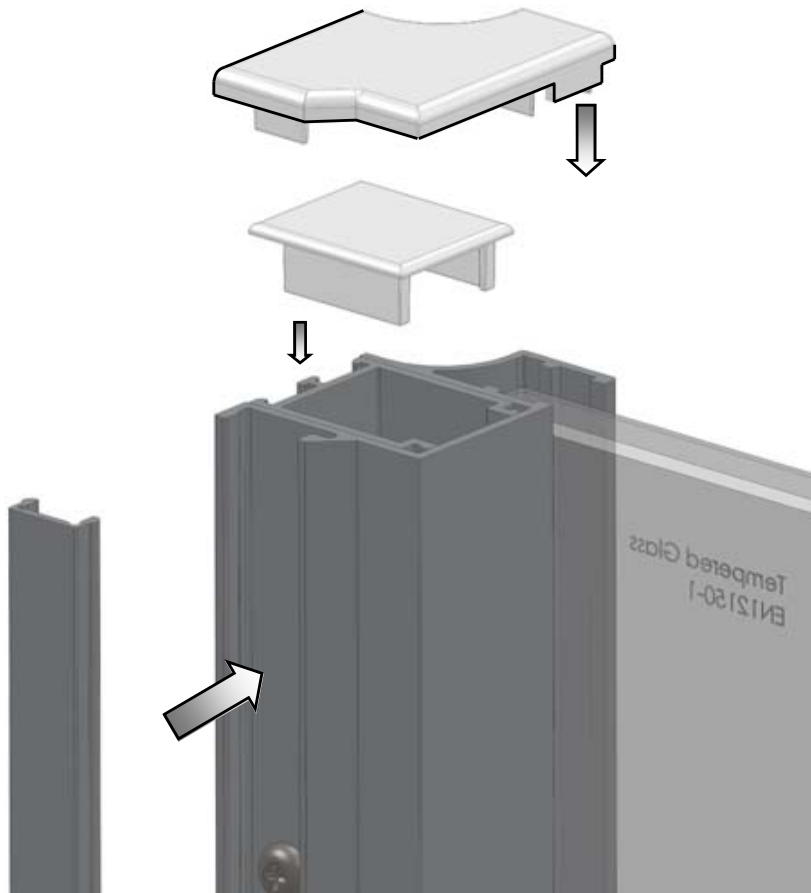

Working from top or bottom, press in cover section.
Fit cover caps to tops of profiles.

Corner Piece :

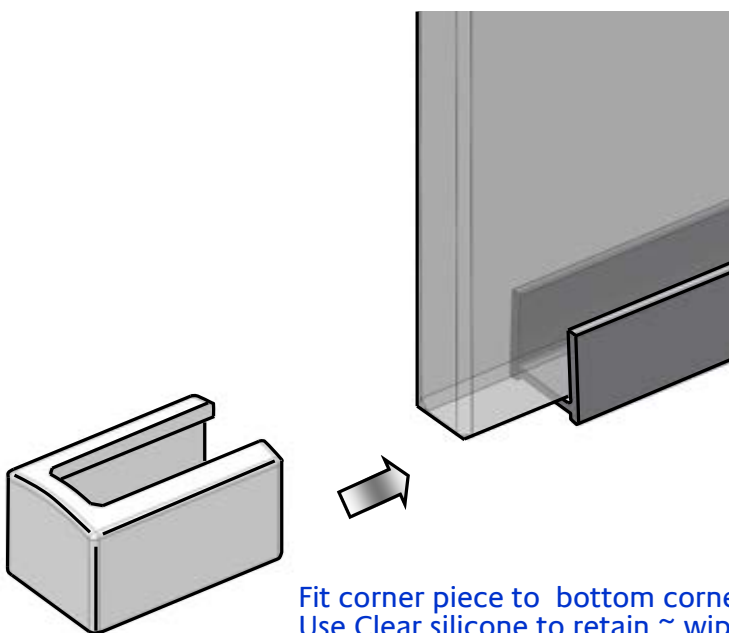

Fit corner piece to bottom corner of 'open' glass edge.
Use Clear silicone to retain ~ wipe off excess.

SEALING :

(E)

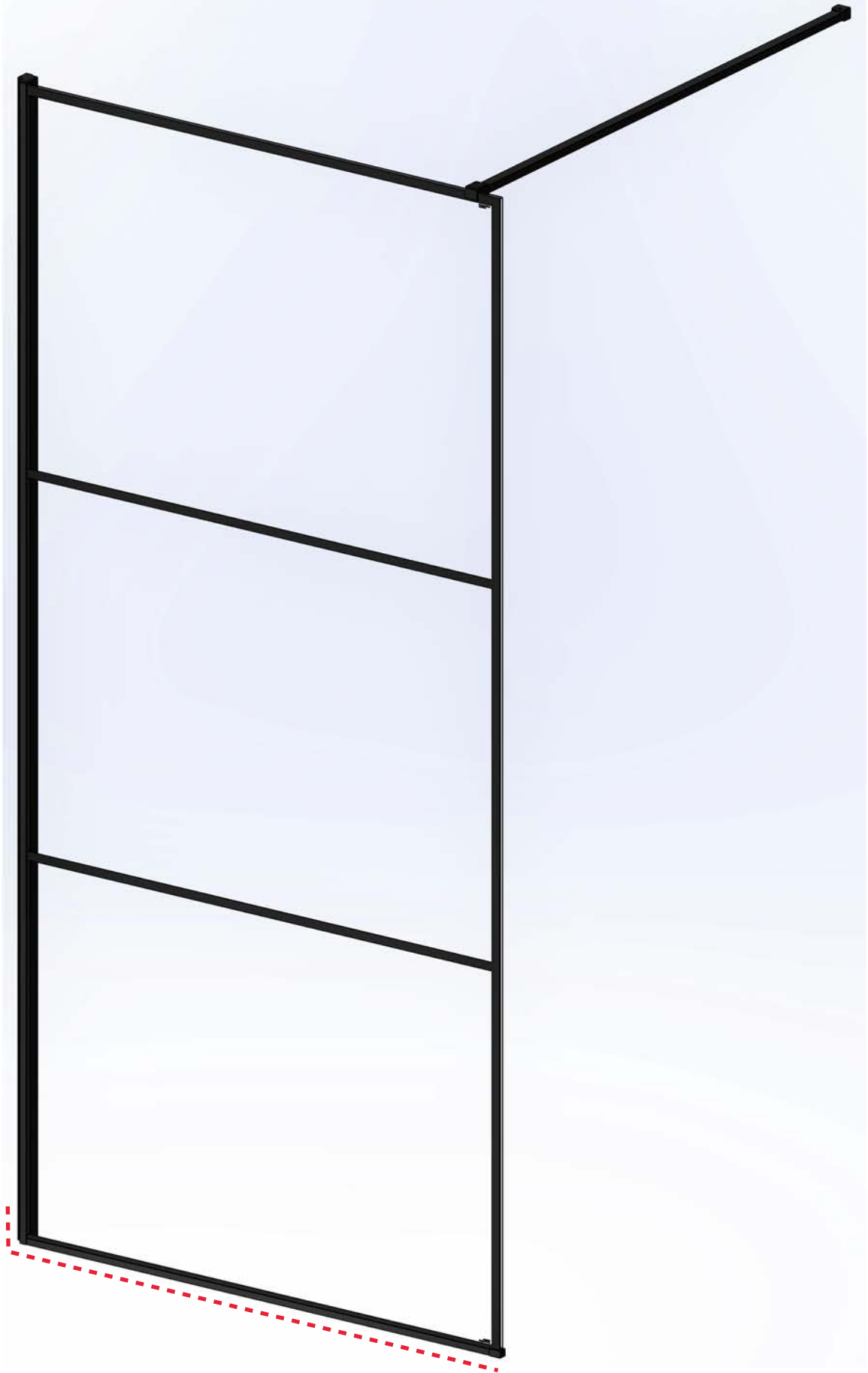

Use of good quality silicone sealant & cleaning / degreasing of all joint areas is recommended.

Apply continuous silicone sealant bead EXTERNALLY ONLY to all panels in contact with tray rim / floor & vertically approx 50mm (2") between wall & wall profile.

BASIC TROUBLESHOOTING :

Leakage :

The sealing method described in these instructions relies on a continuous seal being applied between shower walls & tray before installing the enclosure (see fig A), it ensures a watertight seal around the perimeter of the enclosure to the shower walls & tray.

In the unlikely event of an enclosure leak, water will be visible on the outside of the enclosure itself, or around the perimeter silicone seal ONLY. Water / moisture appearing outside this area (ie at floor level) is normally due to incorrect tray installation.

The foam seal provided on the wall profile will tolerate most grouted joints. If excessively deep joints are present, & leakage does occur, additional silicone sealant may be applied over full length of wall profile / wall joints.



Lakes Bathrooms Ltd

Alexandra Way
Ashchurch
Tewkesbury
Gloucestershire
GL20 8NB

Service England, Scotland, Wales

8.30am—5pm Mon ~ Thurs

8.30am—4.30pm Fri

Tel / HELPLINE : 01684 853870

Fax : 01684 857411

www.lakeshoweringspaces.com

Email : admin@lakeshoweringspaces.com

Service : Northern Ireland

Ian A Kernohan

Firtrees

Green Way Industrial Estate

Conlig

Northern Ireland

BT23 7SU

8.30am—5pm Mon ~ Thurs

8.30am—4.30pm Fri

Tel : 02891 270233

Fax : 02891 270597

Email : info@iakonline.com